

COLOR	PART NO.
CLEAR	3001200214

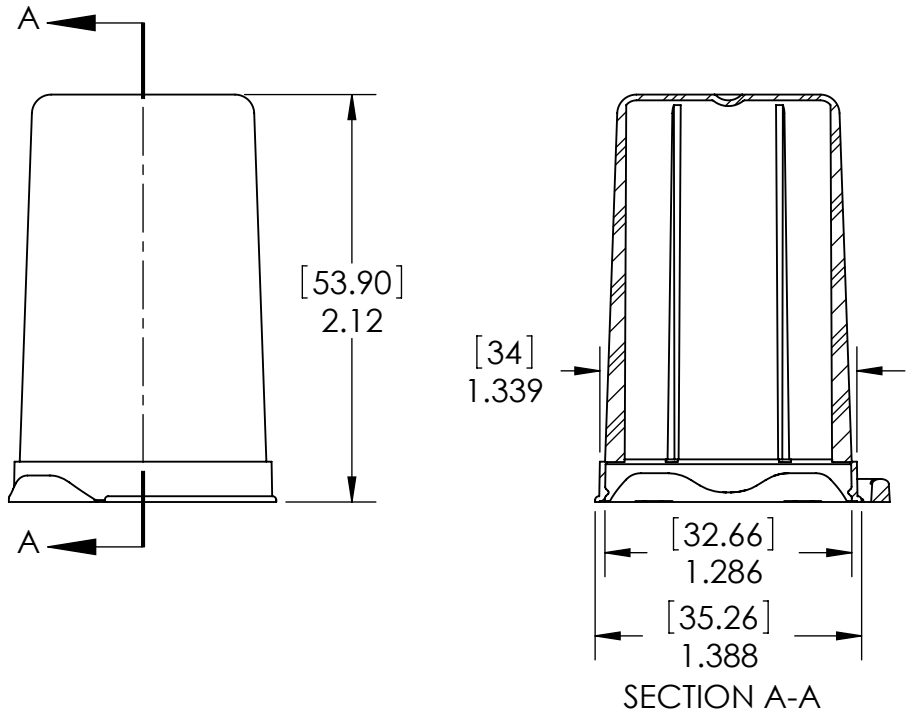

PROPRIETARY AND CONFIDENTIAL
 THE INFORMATION CONTAINED IN THIS DRAWING IS THE SOLE PROPERTY OF CLAYTON CORPORATION. ANY REPRODUCTION IN PART OR AS A WHOLE WITHOUT THE WRITTEN PERMISSION OF CLAYTON CORPORATION IS PROHIBITED.

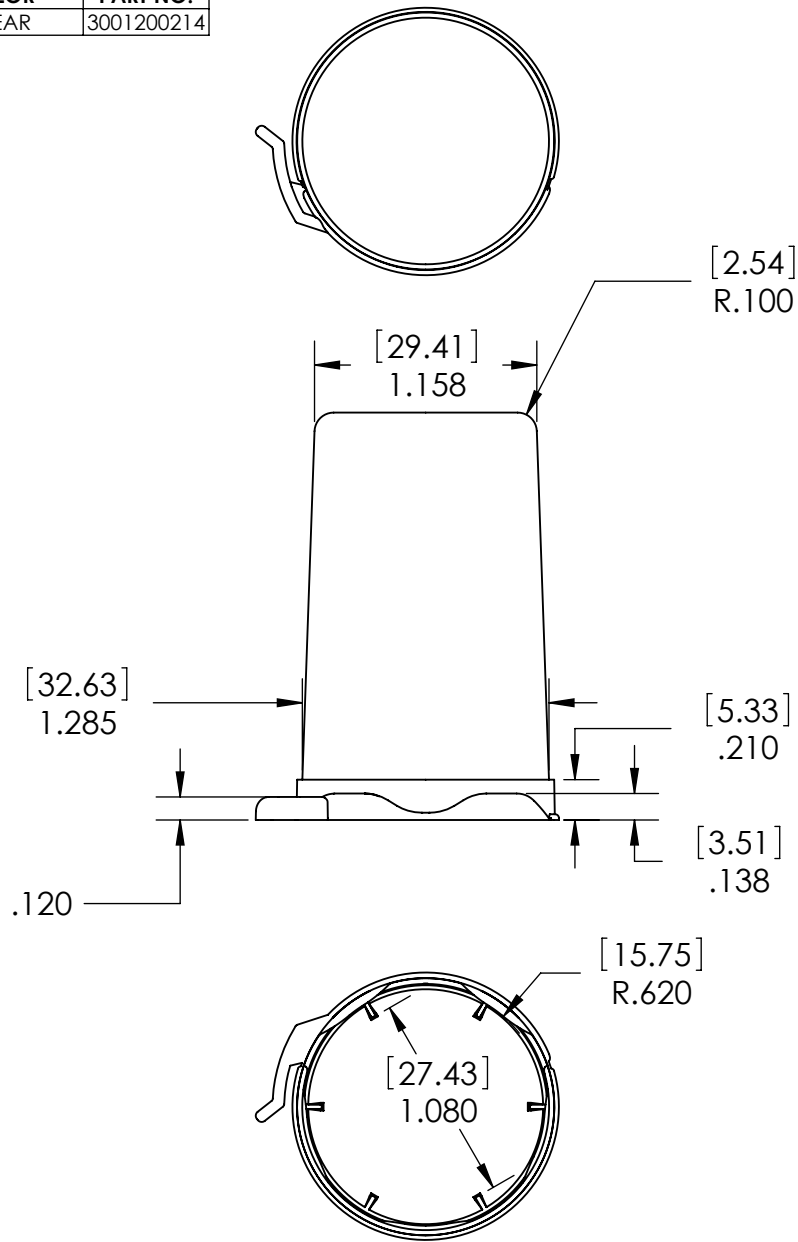

866 HORAN DR.,
 FENTON, MO 63026
 636-349-5333

DRAWN BY: KJR		DATE: 2-18-08	TITLE: TE SW 238 Cover	
CHECKED BY:		7-14-10	SIZE: A	REV F
Tolerances:		DECIMAL INCHES: 0.0 +/- .015" 0.00 +/- .010" 0.000 +/- .005"	PART #: 30012002XX	SCALE: 1:1
		ANGULAR: +/- .10 DEG.	MATERIAL: Olefin Polymer	SHEET 1 OF 2



866 Horan Drive
 Fenton, MO 63026 USA
 1-800-729-8220
 1-636-349-5333
 www.claytoncorp.com

SPECIFICATION SHEET
TE SW 238 Cover

Cover Part Number: 30012002XX

Cover Information:

Parameter	Information
Food Grade	Yes
Weight†	English: 0.14 oz.; Metric: 4.0 g
Material	Olefin Polymer
Appearance	Variable

Carton Information:

Item	English	Metric
Quantity	1,500	1,500
Size	L: 23 in. x W: 15 in. x H: 18 in.	L: 58.4cm x W: 38.1cm x H: 45.7cm
Weight†	15.7 lbs.	7.1 kg

Pallet Information:

Item	USA	International
Style	USA	USA
Quantity	30,000	15,000
Size	L: 40 in. x W: 48 in. x H: 78 in.	L: 101.6cm x W: 121.9cm x H: 106.7cm
Weight†	354 lbs.	89 kg

Warehouse Storage Information:

Condition	English	Metric
Location	Dry Protected Area	Dry Protected Area
Temperature	40°F — 100°F	4.4°C — 37.8°C
Time	Up to 5 years	Up to 5 years

† Weights are approximates

Approved By: Brennan Fogarty

Date: 10/5/2021